

Spare parts list

# 19784 Camera stand

19784-100-55 - black

\*Rev03

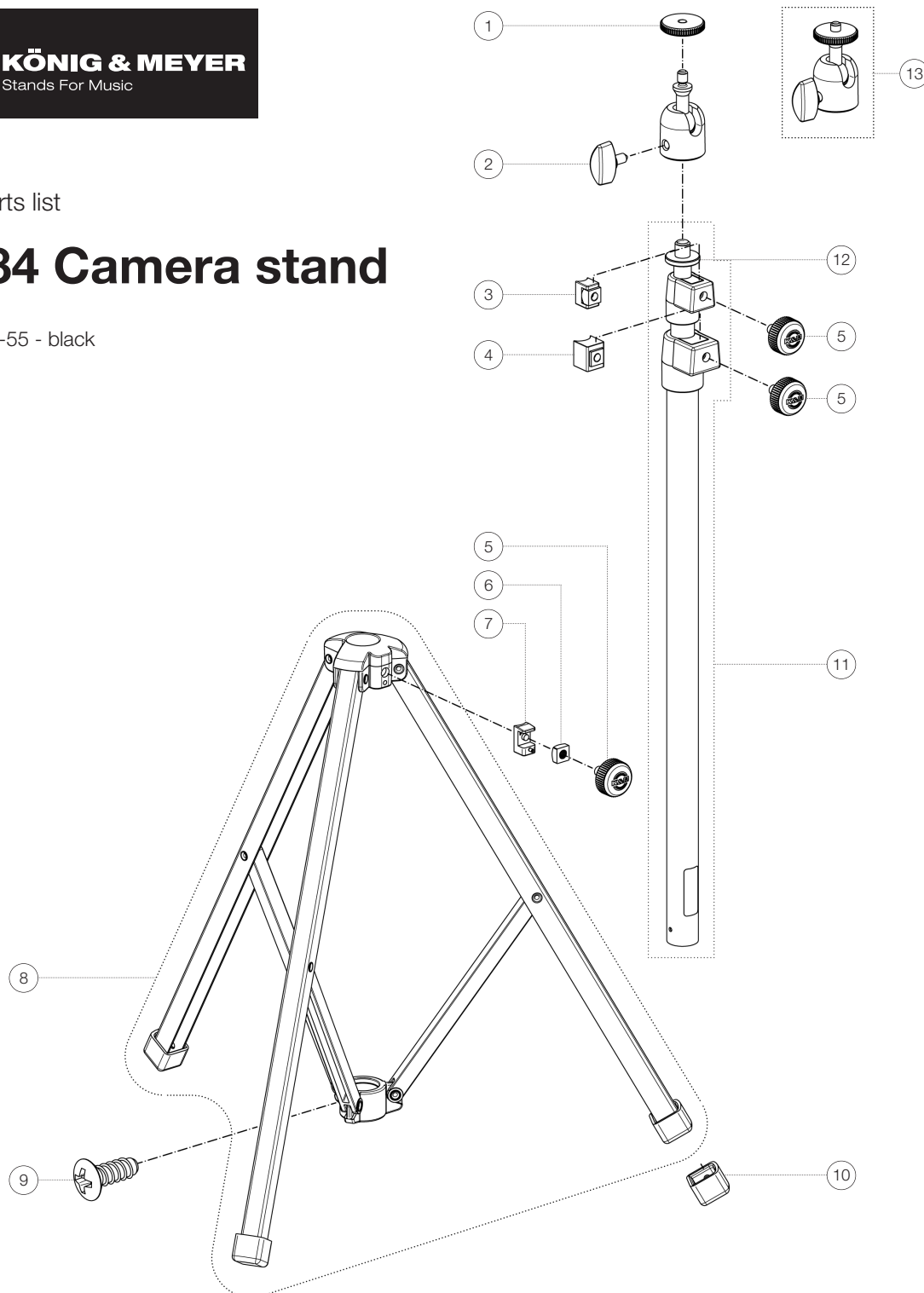

Position	Description	Article No.	Quantity
1	Aluminum knurled washer 1/4"	4-19950-1-35	1
2	Clamping screw M6 x 12 mm	01-83-711-55	1
3	Clamping element R5.5 complete	6-86615-1-55	1
4	Clamping element R7.5 complete	6-86632-1-55	1
5	Knurled screw with logo M6 x 16 mm	01-82-834-55	3
6	Square nut M6	03-08-305-29	1
7	Clamping element with pin R8	01-86-634-55	1
8	Base complete	6-10065-2-55	1
9	Countersunk-head tapping screw	03-02-655-25	1
10	End cap	01-94-660-55	3
11	Rod combination complete	6-20410-3-55	1
12	Aluminum knurled washer 3/8"	03-31-550-15	1
13	Universal joint 1/4"	6-19781-1-55	1